

YTX4L-BS [12V4Ah]

Specifications

Nominal Voltage		12V
Rated capacity (10 hour rate)		4Ah
CCA (-18°C)		55A
Dimensions	Length	113±2mm(4.45inch)
	Width	69±2mm(2.72inch)
	Height	89±2mm(3.50inch)
	Total Height	89±2mm(3.50inch)
Approx. Weight		1.52kg(3.35lbs)

Outer dimensions (mm)

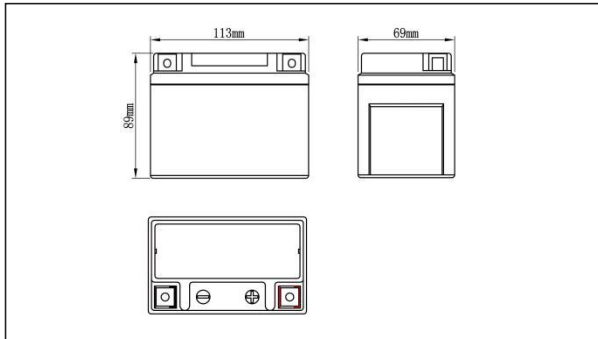

Terminal Type

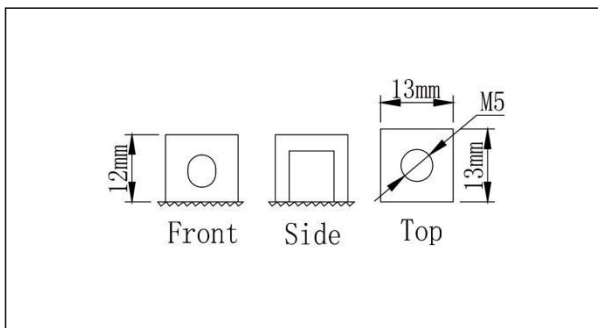

Construction

Component	Positive plate	Negative plate	Container	Cover	Separator	Electrolyte	Safety valve	Terminal
Raw material	Lead dioxide	Lead	ABS	ABS	AGM	Sulfuric acid	Rubber	Lead

Discharge Characteristic (25°C/77°F)

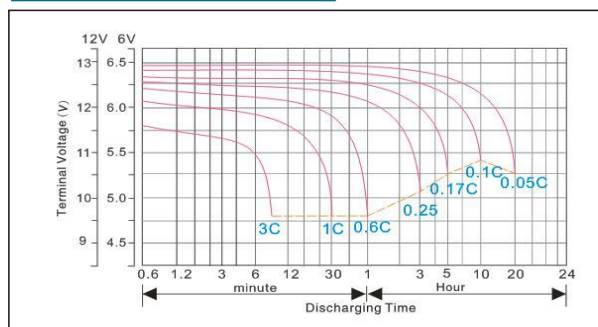

Self Discharge Characteristics

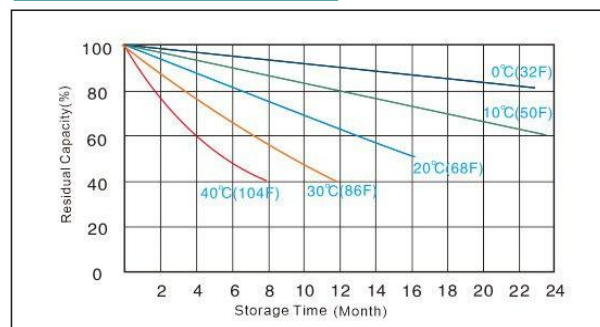

Note: The above characteristics data can be obtained within three charge or discharge cycle.

